



Terminals and hooks



▲ 05.663.xx



▲ 05.664.xx

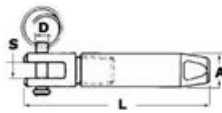
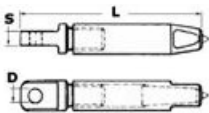

Terminals made of AISI 316 stainless steel for PARAFIL cables

Terminals used to create stanchion stays. For Parafil cables.

Code	Version	Line Ø mm	S mm	D mm	L mm	A mm
05.663.07	With eye	7	6,5	6,1	74	11
05.663.09	With eye	9	7	6,1	74	14
05.664.07	With eye	7	6	4,5	75	11
05.664.09	With eye	9	6	4,5	76	14



Terminals for stainless steel lifelines

Easy installation in a matter of seconds, fitted with stainless steel side socket-head screws.

Code	Version	For plastic-coated cables Ø mm	For bare cables Ø mm
05.662.06	With eye	6	5/6
05.662.08	With eye	8	7/8
05.762.06	With fork	6	5/6
05.762.08	With fork	8	7/8



Pelican hook shackle for openable guardrails

Made of **stainless steel**, fitted with self-regulator, can be used with 6/8 mm rigging screws or mounted directly on the line.

Code	A mm	B mm	D opened mm	D closed mm
05.146.00	6,5	13,5	120	95



Stainless steel terminal with T coupling

Press-fitting on stainless steel cables.

Code	For cables Ø mm
05.192.03	3
05.192.04	4
05.192.05	5
05.192.06	6
05.192.08	8
05.192.10	10



Pelican hook shackles, openable

Made of mirror polished **stainless steel**, includes press-fitting stay terminal.

Code	S.S. Cable Ø mm	Coated	Thread mm
05.283.01	3	3x6	6
05.283.02	4	4x7/8	6
05.283.04	4	4x7/8	8
05.283.03	5	5x10	8

Press-fitting terminals made of AISI316 stainless steel

To be applied on the end of steel wire cables and to make shrouds, forestays, etc.

Code	Version	Ø cable size mm	D3 mm	D1 mm	D2 mm	L2 mm	A mm
05.190.25	Eye	2,5	5,5	2,5	5,5	32	3
05.190.03	Eye	3	6,5	3,5	6,35	38	4
05.190.04	Eye	4	8,5	4,4	7,5	45	5
05.190.05	Eye	5	10,5	5,3	9	51	6
05.190.06	Eye	6	13	6,3	12,5	64	8
05.190.07	Eye	7	13	7,5	14,3	70	9
05.190.08	Eye	8	14,5	8,4	16	83	10
05.190.10	Eye	10	16,3	10,5	17,8	89	11
05.190.12	Eye	12	19,3	12,5	21,4	105	15
05.191.25	Toggle	2,5	5	2,5	5,5	32	-
05.191.03	Toggle	3	5	3,5	6,35	38	-
05.191.04	Toggle	4	8	4,4	7,5	45	-
05.191.05	Toggle	5	10	5,3	9	51	-
05.191.06	Toggle	6	12	6,3	12,5	64	-
05.191.08	Toggle	8	12	8,4	16	83	-
05.191.10	Toggle	10	16	10,5	17,8	89	-
05.191.12	Toggle	12	19	12,5	21,4	105	-
05.193.03	Swivel toggle	3	6,3	3,5	6,35	38	-
05.193.04	Swivel toggle	4	8	4,4	7,5	45	-
05.193.05	Swivel toggle	5	9,5	5,3	9	51	-
05.193.06	Swivel toggle	6	11	6,3	12,5	64	-



AISI 316 stainless steel terminals, Danish system

Fast and simple installation by placing the steel cable into the hole.

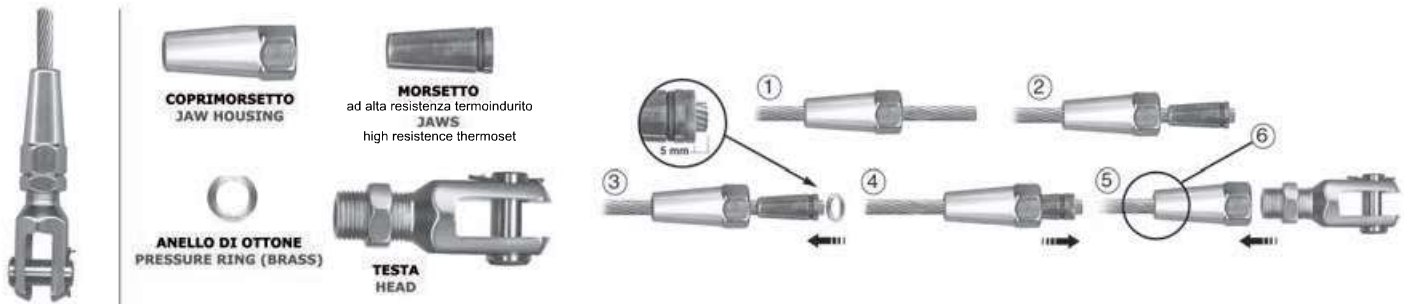

Eyelet terminals

To be used with AISI316 stainless steel 19/49/133-wire ropes.

Code	For cables mm	L3 mm	A mm	D1 mm	D2 mm	Break load kg
05.219.03	3	58	6	3	6,5	700
05.219.04	4	68	7	4	8,3	1500
05.219.05	5	78	8	5	10,3	2180
05.219.06	6	94	9	6	12,3	3700
05.219.08	8	116	10,5	8	14,3	5600
05.219.10	10	131	13	10	16,3	8300

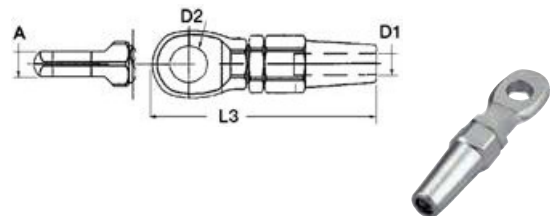

Fork terminals

To be used with AISI316 stainless steel 19/49/133-wire ropes.

Code	For cables mm	L3 mm	A mm	D1 mm	D2 mm	Break load kg
05.408.03	3	63	6	3	6	700
05.408.04	4	73	8	4	8	1550
05.408.05	5	80	10	5	10	2180
05.408.06	6	92	12	6	12	3700
05.408.08	8	113	14	8	14	5600
05.408.10	10	131	16	10	16	8300

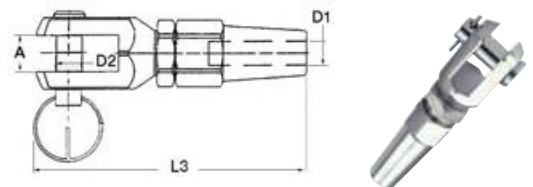

Terminals for fitting into tensioners with right metric screw threads

To be used with AISI316 stainless steel 19/49/133-wire ropes.

Code	For cables mm	L3 mm	D1 mm	G metric mm	Break load kg
05.004.06	3	47	3	6	700
05.004.08	4	57	4	8	1500
05.004.10	5	63	5	10	2180
05.004.12	6	80	6	12	3700
05.004.14	8	89	8	14	5600

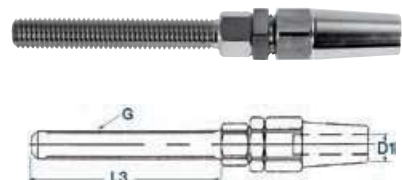

Press-fitting cable terminals with ball head, made of AISI 316 stainless steel

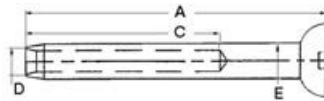

Code	Cable Ø mm	A mm	C mm	D mm	E mm
05.200.04	4	69	45	4,4	7,5
05.200.05	5	79	51	5,3	9
05.200.06	6	90	64	6,5	12,58
05.200.07	7	94	70	7,5	14,2
05.200.08	8	116	83	8,4	16

Terminal slots made of stainless steel

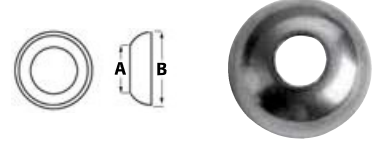

Code	Cable Ø mm	A mm	B mm
05.201.04	3/4	9	26
05.201.05	5	11,2	26
05.201.07	6/7	16	26
05.201.12	8/10	20	34

Lifeline accessories, thimbles



AISI316 stainless steel base plate

For deck mounting of stainless steel cast lifelines. Extra sturdy.

Code	Eye mm	mm
05.860,87	10	62x38

Stainless steel thimbles

To prevent eye splicings from chafing on ropes or stainless steel cables.



▲05.326.xx



▲05.327.xx

AISI stainless steel (standard version)	AISI stainless steel (heavy version)	mm	ORDER BY BOX
05.326.02	-	2	10
05.326.25	-	2,5	10
05.326.03	-	3	10
05.326.04	-	4	10
05.326.05	-	5	10
05.326.06	-	6	10
05.326.08	-	8	10
05.326.10	-	10	10
05.326.12	-	12	10
05.326.14	-	14	10
05.326.16 (60 g)	05.327.16 (125 g)	16	-
05.326.18 (78 g)	05.327.18 (156 g)	18	-
05.326.20 (110 g)	05.327.20 (266 g)	20	-
05.326.22 (184 g)	05.327.22 (326 g)	22	-
05.326.24 (224 g)	05.327.24 (505 g)	24	-
-	05.327.28 (590 g)	28	-
-	05.327.30 (930 g)	30/32	-
-	05.327.34 (1320 g)	34/38	-
-	05.327.40 (2085 g)	40	-

Nylon thimble

Made of **white nylon**. To prevent eye splicings from chafing on fabric or stainless steel cables.



Code	mm	ORDER BY BOX
05.328.05	5	20
05.328.06	6	10
05.328.08	8	10
05.328.10	10	10
05.328.12	12	20
05.328.14	14	10
05.328.15	15/16	10
05.328.18	18	10
05.328.20	20	10
05.328.22	22	10
05.328.24	24	10

U Douglas Marine



bik® thimble made of elastomer

PATENT

Made of special black elastomer.

For elastic mooring, they avoid the mooring line to undergo stresses.

Code	Per lines Ø mm	Elastic load kg	Colour
05.380.12	12-14	160	Black
05.380.16	16-18	250	Black
05.380.20	20-22	500	Black

Quick-coupling terminals for textile rig



New Eye terminals for textile rig

ROPE LINE Made of polished AISI316 stainless steel.

Code	Ø-rope mm	←→ mm				Breaking load Kg
		A	D2	D3	L1	
05.220.04	4	5	8,5	8	45	1900
05.220.05	5	6	10,5	12	58,5	3200
05.220.06	6	9	13	14	71	5500

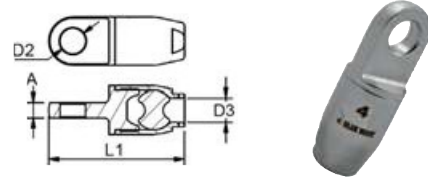

New Fork terminals

ROPE LINE Made of polished AISI316 stainless steel.

Code	Ø-rope mm	←→ mm				Breaking load Kg
		A	B	C	L1	
05.221.04	4	6,5	16	9	53	1900
05.221.05	5	9	21	11	67	3200
05.221.06	6	11	26	13,5	83	5500

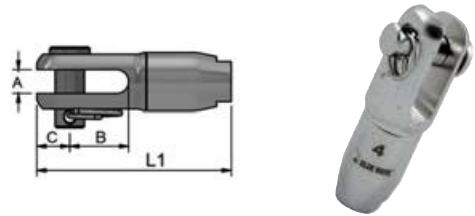

New Threaded terminals

ROPE LINE Made of polished AISI316 stainless steel.

Code	Ø-rope mm	←→ mm			Breaking load Kg
		G	L1	L2	
05.222.04	4	5/16"	95	57	1900
05.222.05	5	3/8"	111	63	3200
05.222.06	6	7/16"	126	68	4600

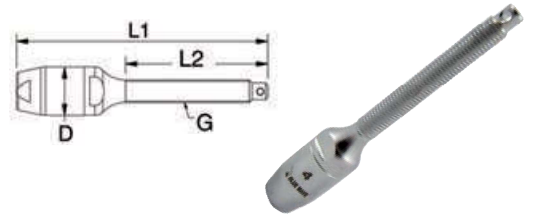

New Lifeline textile system

ROPE LINE Made of polished AISI316 stainless steel.

Code	Description	Rope Ø mm	Thread	Pin Ø mm	Breaking load kg
05.230.01	Turnbuckle with chromed open cage	4	5/16"	8	1700
05.230.02	Single-snap shackle	-	M6	-	500
05.230.03	Threaded terminal for textile halyards to pair with shackle 05.230.02 and/or turnbuckle 05.230.01	4	M6	-	1100
05.221.04	Fork terminal	4	-	8	1900
05.231.00	Nylon sleeve for 10-mm bores	-	-	-	-

